

OXVA

xlim^{CRC}

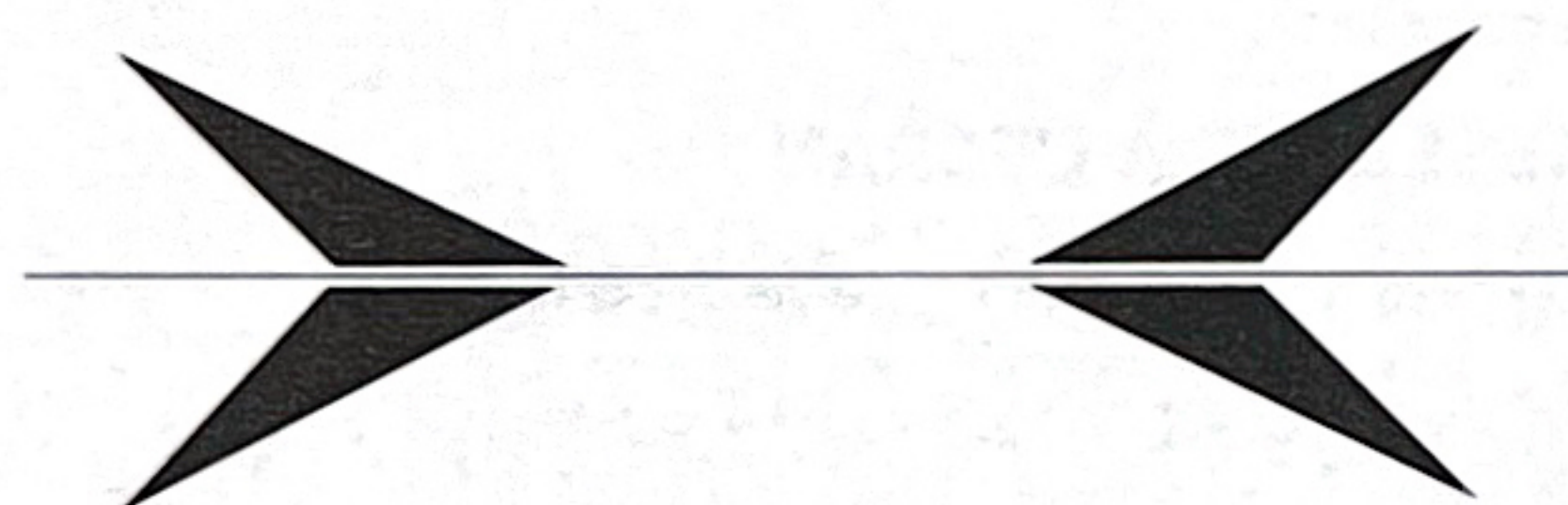

User Manual

STRUCTURE

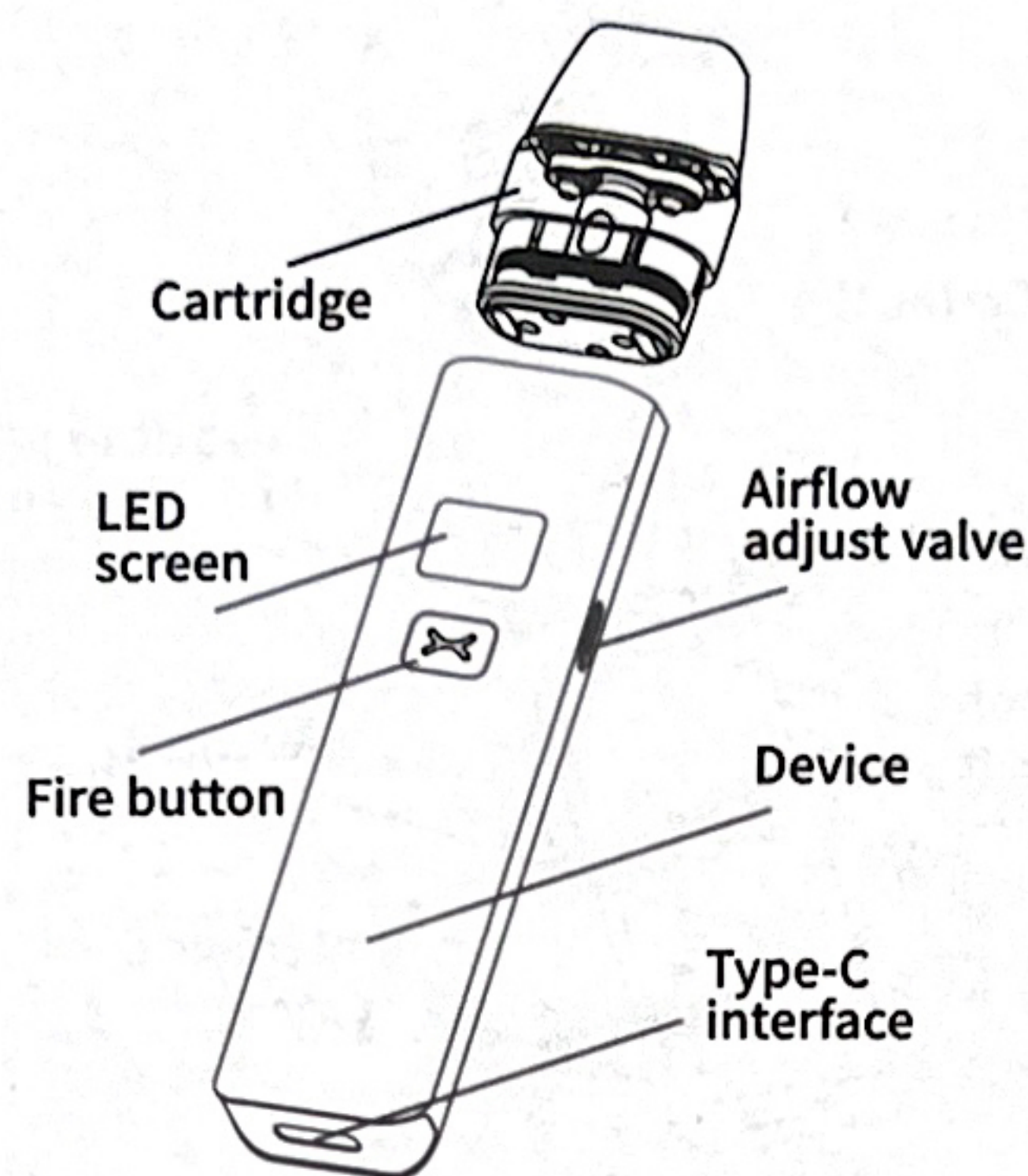

SPECIFICATION

Size	14mm×24mm×111mm
Weight	45g
Cartridge capacity	2ml
Battery capacity	900mAh
Screen size	0.42 inch
Material	Aluminum alloy+PCTG
Spec of coils	0.6Ω 20-25W A1 0.8Ω 12-16W A1

GUIDANCE

1. FILLING JUICE

Fill the e-juice into the cartridge.

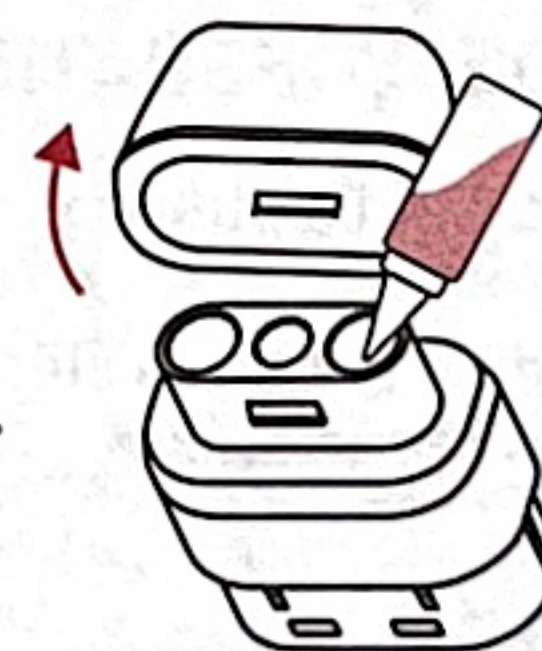

TIPS

- 1) After filling the e-juice into a new cartridge, please wait for at least 5~8 minutes before vaping to avoid dry burning.
- 2) After filling the juice, please close as soon as possible to avoid leaking.

2. POWER ON/OFF

Press the fire button 5 times consecutively to turn on/off the device.

3. VAPE

After 5~8 minutes of filling the e-juice into the cartridge, you could draw to vape directly or press the fire button to vape.

4. ADJUST THE AIRFLOW

Slide the airflow adjusting valve to adjust the airflow.

5. ADJUST THE WATTAGE

Press the fire button 3 times. When the power on the screen is flashing, press the fire button to adjust the power. Every time you press, the power will be changed by 0.5W. Long press to quickly adjust the power.

The Photon chip will generate the power range according to the resistance of coil to protect the coil from burning. The power range of 0.6Ω pod is 5-25W and 0.8Ω pod is 5-18W.

6. CHARGING

Connect the charging cable to the Type-C interface to charge with the charge current of 1A. After fully charged, please cut off the power in time.

7. PUFF CLEAR

Press the fire button 7 times to clear the puff data.

8. LOCK/UNLOCK FIRE BUTTON

Press the fire button 4 times to lock/unlock the fire button. You may still auto draw vape or press the fire button 3 times to adjust the wattage.

SCREEN PROMPTS

BATTERY LOW	The battery is low.
NO ATOMIZER	The cartridge is not detected.
POWER OFF	The device is power off.
SHORT	The short-circuit is detected.
TIMEOUT	The vaping time is over 8s.
TEMP HIGH	The temperature of PCBA is too high.

RECOMMENDED E-JUICE

Freebase Nic 18mg / 24mg

Salt Nic 20-50mg

STATEMENT

1. Please keep away from inflammable and explosive materials to avoid injury.
2. Please don't leave the device unattended while charging.